

Valvole

Valves

Hähne

RV

Valvole e rubinetti in ottone

Brass Valves
Messing Kugelhähne

Valvole di sicurezza

Safety valves
Sicherungshähne

265

Valvole di ritegno

Non-return valves
Rückschlagventile

267

Valvole di scarico rapido

Exhaust valves
Schnellenlüftungsventil

269

Valvole a corsoio

Hand slide valves
Handschiebventile

270

Rubinetti mini ball

Mini ball valves
Mini ball Ventile

271

Rubinetti a sfera

Ball valves
Kugelhähne

273

Valvole unidirezionali

Unidirectional valves
Einweg Hähne

277

Valvole a sfera (serie media)

Ball valves (medium serie)
Kugelhähne (Mittel Serie)

279

Valvole a sfera (serie pesante)

Ball valves (heavy serie)
Kugelhähne (Schwere Serie)

286

Valvole a sfera anti-legionella

Anti-legionella ball valves
Kugelhähne für Anti-Legionellen

291

Valvole a sfera per gas

Ball valves for gas
Kugelhähne für Gas

293

VX

Valvole e rubinetti INOX AISI 316

INOX AISI 316 valves
Kugelhähne Edelstahl AISI 316

295

EV

Elettrovalvole

Solenoid valves
Magnetventile

307

Dati tecnici valvole di sicurezza RV 10-11

Safety valve RV 10-11 technical data

Technischen Daten der Sicherungshähne RV 10-11

Caratteristiche tecniche

Corpo:	OT58 UNI EN 12164
Otturatore:	OT58 UNI EN 12164
Sede:	OT58 UNI EN 12164
Spillo:	OT58 UNI EN 12164
Guarnizione:	NBR-VITON
Molla:	C98 UNI 3823 INOX AISI 302

Technical data

Body:	OT58 UNI EN 12164
Speare valve:	OT58 UNI EN 12164
Seat:	OT58 UNI EN 12164
Needle:	OT58 UNI EN 12164
Washer:	NBR-VITON
Spring:	C98 UNI 3823 INOX AISI 302

Technischen Daten

Gehäuse:	OT58 UNI EN 12164
Blende:	OT58 UNI EN 12164
Sitz:	OT58 UNI EN 12164
Nadel:	OT58 UNI EN 12164
Dichtung:	NBR-VITON
Feder:	C98 UNI 3823 INOX AISI 302

Diametro orificio

1/8" - 1/4"	6 mm
3/8"	10 mm
1/2"	11 mm
3/4"	13 mm
1"	15 mm

Orifice Diameter

1/8" - 1/4"	6 mm
3/8"	10 mm
1/2"	11 mm
3/4"	13 mm
1"	15 mm

Ø Öffnung

1/8" - 1/4"	6 mm
3/8"	10 mm
1/2"	11 mm
3/4"	13 mm
1"	15 mm

Area orificio

1/8" - 1/4"	28,26 mm ²
3/8"	78,5 mm ²
1/2"	94,9 mm ²
3/4"	132,6 mm ²
1"	176,6 mm ²

Orifice Area

1/8" - 1/4"	28,26 mm ²
3/8"	78,5 mm ²
1/2"	94,9 mm ²
3/4"	132,6 mm ²
1"	176,6 mm ²

Fläche

1/8" - 1/4"	28,26 mm ²
3/8"	78,5 mm ²
1/2"	94,9 mm ²
3/4"	132,6 mm ²
1"	176,6 mm ²

Temperatura di esercizio

NBR:	-10 °C ÷ +90 °C
VITON:	-10 °C ÷ +250 °C

Working temperature

NBR:	-10 °C ÷ +90 °C
VITON:	-10 °C ÷ +250 °C

Betriebstemperatur

NBR:	-10 °C ÷ +90 °C
VITON:	-10 °C ÷ +250 °C

Campo di taratura

0 ÷ 18 bar

Setting range

0 ÷ 18 bar

Regulierbereich

0 ÷ 18 bar

Portata effettiva di scarico l/m - Real flow of blowdown lt/m - Effektiver abflussdurchsatz lt/m

BAR	1/8" - 1/4"	3/8"	1/2"	3/4"	1"
1	130	405	449	3572	5946
2	167	550	610	4601	7004
3	350	786	872	5630	8054
4	550	1150	1276	6659	9304
5	920	1850	2053	7688	10554
6	1300	2458	2728	8717	11534
7	1630	3350	3718	10220	12542
8	2500	4300	5413	11728	13492
9	2800	4765	5765	12757	15618
10	3316	5960	6344	13786	16576
11	3450	6871	7626	14815	17857
12	3600	7836	8768	15844	19138
13	3807	9487	10530	16873	20419
14	3904	9758	10831	17902	21700
15	4100	10180	11299	18755	22981
16	4450	11287	12528	19608	24262
17	4700	12468	12700	20461	25543
18	4850	12780	13950	21314	26545

Valvole e rubinetti in ottone

Brass valves

Messing Kugelhähne

RV 10



Valvola sicurezza tarata

Set safety valve
Überdruckventil

Codice/Code	Misure/Size	Tarata/Set	📦
RV100814	G1/4"	8.5 BAR	1
RV101238	G3/8"	12 BAR	1
RV101212	G1/2"	12 BAR	1
RV101234	G3/4"	12 BAR	1
RV101201	G1"	12 BAR	1

RV 11



Valvola sicurezza libera

Free safety valve
Überdruckventil

Codice/Code	Misure/Size		📦
RV110018	G1/8"	1	1
RV110014	G1/4"	1	1
RV110038	G3/8"	1	1
RV110012	G1/2"	1	1

RV 28



Rubinetto spurgo

Draining valve
Entlüftungsventil

Codice/Code	Misure/Size	📦
RV280018	G1/8	50
RV280014	G1/4	50
RV280038	G3/8	20
RV280012	G1/2	20

RV 33



Rubinetto linea con volantino ghiera

Male line valve
Ventil

Codice/Code	F	F1	I	H	L	L1	CH	M	📦
RV330014	1/4	1/4	11	44,5	59,5	21	15	45	10
RV330038	3/8	1/4	11,5	44,5	59,5	20,5	15	45	10
RV330012	1/2	1/4	12,5	44,5	63,5	23,5	22	45	10

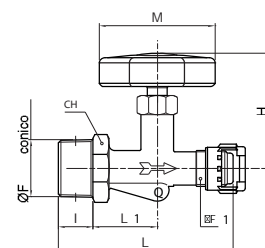

RV 34



Rubinetto linea levetta ghiera

Male line valve
Ventil

Codice/Code	F	F1	I	H	L	L1	CH	M	📦
RV340018	1/8	1/4	9	37,5	46,5	16	13	34	10
RV340014	1/4	1/4	11	44	59,5	21	15	43	10
RV340038	3/8	1/4	11,5	44	59,5	20,5	15	43	10
RV340012	1/2	1/4	12,5	44	63,5	23,5	22	43	10

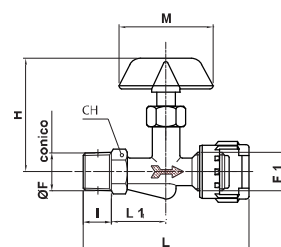

Dati tecnici valvole di ritegno RV 12-14-16-18-20

Non-return valves RV 12-14-16-18-20 technical data

Technischen Daten der Rückschlagventile RV 12-14-16-18-20

Impiego

Le valvole di ritegno sono ottimali per i costruttori di compressori d'aria. Per rispondere alle esigenze del mercato, le valvole di ritegno sono prodotte nelle versioni orizzontali e verticali. Le caratteristiche tecniche ed i materiali impiegati garantiscono un alto grado di affidabilità e di resistenza alle alte temperature pneumatiche a cui vengono sottoposte.

Use

Non-return valves are successfully used in air compressors. Horizontal and vertical versions are available to meet all market requirements. Technical specification and the top quality of materials used, guarantee high reliability and resistance to high pneumatic temperatures.

Verwendung

Die Rückschlagventile sind ideal für Hersteller von Kompressoren. Um den Bedürfnissen des Marktes gerecht zu werden, die Rückschlagventile in horizontaler und vertikaler Ausführung produziert. Die technischen Eigenschaften und die verwendeten Materialien gewährleisten ein hohes Maß an Zuverlässigkeit und Beständigkeit gegen hohe Temperaturen, die pneumatische ausgesetzt sind.

Materiali

Corpo/tappo: Ottone UNI EN 12164 CW 614N. Ottone UNI EN 12165 CW 617N

Elemento di tenuta: FKM (VITON) - 85 Shore. Temperatura di esercizio della pastiglia 200°C NBR - Gomma anticalore - antiolio -80 Shore. Temperatura di esercizio della pastiglia 130°C

Molle: Acciaio INOX - AISI 302

Guarnizione tenuta corpo/tappo: Alluminio ricotto oppure OR in NBR resistenza temperatura 130°C

Materials

Body/cap: Brass UNI EN 12164 CW 614N. Brass UNI EN 12165 CW 617N

Sealing element: FKM (VITON) - 85 Shore. Disk working temperature 200°C or NBR - heat - and oil - proof rubber - 80 Shore. Disk working temperature 130°C

Springs: AISI 302 stainless steel

Body/cap seal: Annealed aluminium, or NBR O-ring resistant to 130°C

Werkstoffe

Gehäuse/Kappe: Messing UNI EN 12164 CW 614N. Messing UNI EN 12165 CW 617N

Dichtungen: FKM (VITON) - 85. Tablette Betriebstemperatur von 200°C NBR - wärmeisolierende Gummi - ölbeständig - 80 Shore. Tablette Betriebstemperatur von 130°C

Feder: Edelstahl - AISI 302 Dichtung Gehäuse/Kappe: reduziert Aluminium oder NBR beständig bis 130°C

Trattamento superficiale

Nichelatura

Surface treatment

Nickel - plating

Oberflächenbehandlung

Nickel

Filettatura

Gas conica ISO 7 - DIN 2999 - BS 21

Thread

Taper gas ISO 7 - DIN 2999 - BS 21

Gewinde

Gas konisch ISO 7 - DIN 2999 - BS 21

Pressione nominale

16 bar

Nominal pressure

16 bar

Nenndruck

16 bar

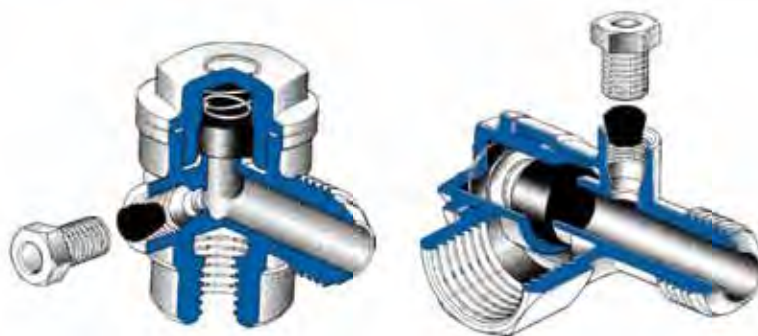

Valvole e rubinetti in ottone

Brass valves

Messing Kugelhähne

RV 12



Valvola orizzontale F.M.

F.M. horizontal non return valve
Horizontalhähne

Codice/Code	Misure/Size	
RV120038	3/8"F. - 3/8"M.	1
RV120012	1/2"F. - 1/2"M.	1

RV 14



Valvola orizzontale maschio-maschio

M.M. horizontal non return valve
Horizontalhähne

Codice/Code	Misure/Size	
RV143838	3/8"M- 3/8"M	1
RV141238	1/2"M- 3/8"M	1
RV141212	1/2"M- 1/2"M	1
RV143412	3/4"M- 1/2"M	1

RV 16



Valvola verticale femmina-maschio

F.M. vertical non return valve
Vertikalhähne

Codice/Code	Misure/Size	
RV161238	1/2"F- 3/8"M	1
RV161212	1/2"F- 1/2"M	1
RV163412	3/4"F- 1/2"M	1
RV163434	3/4"F- 3/4"M	1

RV 18



Valvola verticale maschio-maschio

M.M. vertical non return valve
Vertikalhähne

Codice/Code	Misure/Size	
RV181238	1/2"M- 3/8"M	1
RV183438	3/4"M- 3/8"M	1
RV180134	1"M- 3/4"M	1

RV 20



Valvola verticale femmina femmina

F.F. vertical non return valve
Vertikalhähne

Codice/Code	Misure/Size	
RV200101	1"F. - 1"F	1

Dati tecnici valvole di scarico rapido RV 40-40P-40G

Exhaust valves RV 40-40P-40G technical data

Technischen Daten der Schnellentlüftungsventil RV 40-40P-40G

Applicazioni

Circuiti pneumatici

Applications

Pneumatic systems

Anwendungen

Pneumatikkreisläufe

Pressione

Min. 0,3 BAR / max. 10 BAR

Pressure

Min. 0,3 BAR / max. 10 BAR

Druck

Min. 0,3 BAR / max. 10 BAR

Temperatura

Min. -20°C / max. +80°C

Temperature

Min. -4°F / max. 176°F

Temperatur

Min. -20°C / max. +80°C

Materiali

Corpo/Tappo: ottone UNI EN 12165 CW617N
Elemento di tenuta: Elastomero poliuretano
Guarnizione tenuta corpo/tappo: Nylon

Materials

Body/cap: Brass UNI EN 12165 CW 617N
Sealing element: Polyurethane elastomer
Body/cap seal: Nylon

Werkstoffen

Gehäuse/Kappe: Messing UNI EN 12165 CW 617N
Dichtungen: Polyurethan Elastomer
Dichtung Gehäuse/Kappe: Nylon

Trattamento superficiale

Nichelatura

Surface treatment

Nickel-plating

Oberflächenbehandlung

Nickel

Filettatura

Gas cilindrica ISO 228 (BSPP)

Thread

Cylindrical GAS ISO 228 (BSPP)

Gewinde

Gas zylindrisch ISO 228 (BSPP)

RV 40



Valvola di scarico rapido

Quick exhaust valve

Schnellentlüftungsventile

Codice/Code	F"	I	H	H1	CH	CH1	E	☒
RV4000M5	M5	4,5	24,8	15,6	10	10	10,5	20
RV400018	1/8	8	42	28	14	14	19,5	20
RV400014	1/4	11	53	34,5	19	19	25	20
RV400038	3/8	12	58	36	21	21	26	10
RV400012	1/2	14	71	44	26	26	35	5
RV400034	3/4	18	86	52	32	32	38,5	5
RV400001	1	19	94	56	38	38	42	5

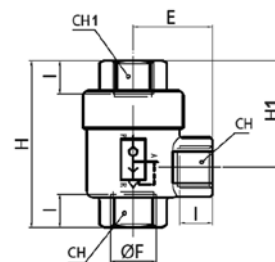

RV 40P



Membrana per valvola di scarico rapido

Membrane for quick exhaust valve

Membrane für Schnellentlüftungsventile

Codice/Code	A	B						☒
RV40PM5	13,5	4,5						1
RV40P18	20,5	5						1
RV40P1438	25,5	5,8						1
RV40P12	35,5	8,2						1
RV40P3401	40,5	9						1

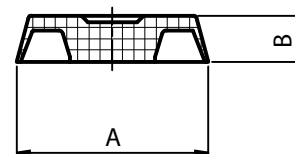

RV 40G



Guarnizione in nylon per valvola di scarico rapido

Nylon seal for quick exhaust valve

Dichtung Nylon für Schnellentlüftungsventile

Codice/Code	A	B	C					☒
RV40GM5	17	12,4	0,8					1
RV40G18	23,8	20	1					1
RV40G1438	28,5	24	1					1
RV40G12	38,6	32	1,5					1
RV40G3401	45	38	1,5					1

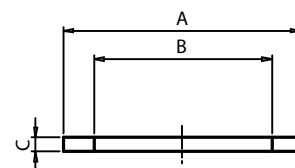

Valvole e rubinetti in ottone

Brass valves

Messing Kugelhähne

Dati tecnici valvola a corsoio RV 41-41A

Hand slide valve RV 41-41A technical data

Technischen Daten der Handschiebeventile RV 41-41A

Descrizione

Valvola manuale per intercettazione e scarico delle tubazioni di aria compressa.

Funzionamento

Lo spostamento del corsoio provoca da un lato l'apertura della valvola e dall'altro la chiusura, con messa allo scarico della condotta a valle.

Impiego

Aria compressa
Aria compressa lubrificata
Gas vari (gas che scaricati in atmosfera non siano pericolo per persone e cose)

Pressione di esercizio

10 bar - 1000 kPa MAX

Temperatura di esercizio

-5°C ÷ +70 °C

Materiali

Corpo: Ottone CW 614N C romato
Corsoio: Alluminio anodizzato nero, blu, rosso
O-Ring: NBR 70
Anello elastico: Acciaio

Misure

M5 - 1/8" - 1/4" - 3/8" - 1/2" - 3/4"

Estremità

con filetti G - GA ISO 228 e NPT (Rp - R ISO 7 a richiesta)

Description

Manual valve for the shut-off and discharge of compressed air hoses.

Function

Movement of the slide causes the opening of the valve on one side and its closing on the other, with discharge to the downstream conductor.

Use

Compressed air
Lubricated compressed air
Various gasses (Except gasses which can be dangerous for people and things)

Working pressure

10 bar - 1000 kPa MAX

Working temperature

+23°F ÷ +160°F

Materials

Body: Brass CW614N chrome plated
Slider: Anodized Aluminium black, blue, red
O-Ring: NBR 70
Elastic ring: Steel

Sizes

M5 - 1/8" - 1/4" - 3/8" - 1/2" - 3/4"

Extremity

With threads G - GA ISO 228 e NPT (Rp - R ISO 7 on request)

Beschreibung

Handventil zum Abfangen und Abfuhr von Druckluft Rohrleitungen.

Funktionsweise

Die Verlagerung des Schiebers von einer Seite bewirkt, das Ventil zu öffnen und die andere geschlossen, mit der Inbetriebnahme des Abgases Stromabwärtsleitung.

Verwendung

Druckluft
Geölte Druckluft
Verschiedene Gase (Gase in die Atmosphäre entlassen werden keine Gefahr für Personen und Sachen)

Betriebsdruck

10 bar - 1000 kPa MAX

Betriebstemperatur

-5°C ÷ +70 °C

Werkstoffe

Gehäuse: Messing CW 614N verchromt
Schieber: eloxierte aluminium schwarz, blau, rot
O-Ring: NBR 70
Elastischen Ring: Stahl

Maße

M5 - 1/8" - 1/4" - 3/8" - 1/2" - 3/4"

Ende

Mit Gewinde G - GA ISO 228 e NPT (Rp - R ISO 7 auf Anfrage)

RV 41



Valvola a corsoio

Hand slide valve
Handschiebeventile

Codice/Code	F"	D	I	L	SW			
RV4100M5	M5	14	5	30.5	10			10
RV410018	G1/8"	25	9	48	14			10
RV410014	G1/4"	30	11.5	58	19			10
RV410038	G3/8"	35	12	70	22			10
RV410012	G1/2"	40	15	75	27			10
RV410034	G3/4"	50	16.5	83	32			10

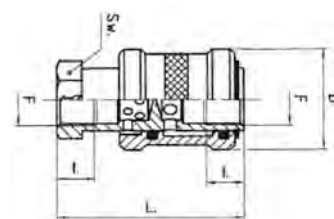

RV 41A



Valvola a corsoio in alluminio

Aluminum hand slide valve
Aluminum Handschiebeventile

Codice/Code	A-B	L1	L2	L	D	DE	SW	
RV41A0018	G1/8"	8	8	40	6	25	14	10
RV41A0014	G1/4"	9.5	9.5	46	8	30	17	10
RV41A0038	G3/8"	10.5	10.5	52	10	35	21	10
RV41A0012	G1/2"	12	12	62	12.5	40	26	10

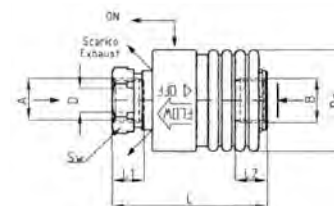

Dati tecnici rubinetti mini ball RV 22-23

Mini ball RV 22-23 technical data
Technische Daten der Mini Ball RV 22-23

Materiali Corpo valvola: CW 617N UNI-EN 12165 ricavato da stampaggio a caldo di barra estrusa Asta: CW 614N UNI-EN 12164 Ghiera: CW 614N UNI-EN 12164 Sfera: CW 614N UNI-EN 12164 nichelata Guarnizioni della sfera: PTFE (Teflon) Anello di tenuta asta: FKM (Viton) Leva: Nylon 66 caricato vetro	Materials Valve body: CW 617N UNI-EN 12165 made from hot-forged extruded bars Stem: CW 614N UNI-EN 12164 Retainer: CW 614N UNI-EN 12164 Ball: CW 614N UNI-EN 12164 nickel plated Ball gaskets: PTFE (Teflon) Stem sealing ring: FKM (Viton) Lever: glass-charged nylon 66	Werkstoffen Ventilkörper: CW 617N UNI-EN 12165 gebildet durch heiße Formung des extrudierten bar Auktion: CW 614N UNI-EN 12164 Ring: CW 614N UNI-EN 12164 Kugel: CW 614N UNI-EN 12164 vernickelt Kugeldichtung: PTFE (Teflon) Dichtungsring des Stabes: FKM (Viton) Hebel: Nylon 66 Glas
Finitura Cromata	Surface finishing Chrome plated	Endbehandlung Chrom
Manovra Rotazione di 90° della leva	Operation 90° rotation of lever	Betrieb 90°-Drehung des Hebels
Diametro nominale Da 5.5 mm	Nominal diameter From 5.5 mm	Diameter von 5.5 mm
Pressione di esercizio 0 - 10 bar a 90 °C	Working pressure 0 - 10 bar at 90 °C	Druck 0 - 10 bar at 90 °C
Limiti di temperatura - 10 °C / + 90 °C	Temperature limits 14°F / 194°F	Temperaturgrenzen - 10 °C / + 90 °C
Direzione di passaggio Bidirezionale	Direction Two-ways	Richtung Bidirektional
Disponibile con clip rossa cod. CLIPR2223 o clip blu cod. CLIPB2223	Available with red clip cod. CLIPR2223 or blue clip cod. CLIPB2223	Mit rotem Clip Kode CLIPR2223 oder blauem Clip Kode CLIPB2223



Valvole e rubinetti in ottone

Brass valves
Messing Kugelhähne

RV 22

new



Rubinetto mini ball maschio-femmina

Male-female mini ball valve
Mini Kugelhähne

Codice/Code	F"	F1"	ØA	L1	L2	L	
RV221818	G1/8	R1/8	5.5	18.5	20.5	39	10
RV221414	G1/4	R1/4	5.5	20.5	24	44.5	10

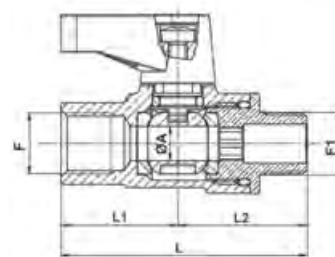

RV 23

new



Rubinetto mini ball femmina-femmina

Female-female mini ball valve
Mini Kugelhähne

Codice/Code	F"	F1	ØA	L1	L2	L	
RV231818	G1/8	G1/8	5.5	18.5	21	39.5	10
RV231414	G1/4	G1/4	5.5	20.5	24	44.5	10

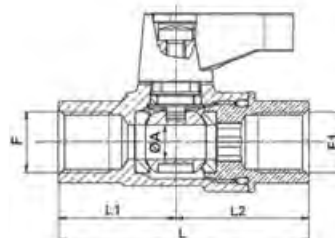

CLIP

new



Clip per mini ball RV22-23

Clip for mini ball RV22-23
Clip für Minikugelhahn RV22-23

Codice/Code	Colore/Color/Farbe	
CLIPR2223	Rosso - Red - Rot	10
CLIPB2223	Blu - Blue - Blau	10

Dati tecnici rubinetti a sfera RV 36-37-38-39-42-43

Ball valve RV 36-37-38-39-42-43 technical data

Technische Daten der Kugelhähne RV 36-37-38-39-42-43

Applicazioni

Circuiti pneumatici, oleodinamici e idraulici. Le valvole sono anche usate per medio/basso vuoto pneumatico.

Applications

Pneumatic, oil-dynamics and hydraulic circuits. They can also be used for medium/low vacuum pneumatic.

Anwendungen

Pneumatischen Schaltungen und hydraulische Systeme. Die Ventile sind auch für mittel/niedrig Vakuum Reifen verwendet.

Tubi di collegamento

Tubi metallici in genere. Con rinforzo interno per tubi plastici (PA, PU, PE etc.).

Connecting tubes

Metallic pipes in general. With internal reinforcement for plastic tubes.

Schlauch

Metallrohre im Allgemeinen. Mit innerer Verstärkung für Kunststoffrohre (PA, PU, PE etc.).

Pressione

Pressione massima 20 bar

Pressure

Max pressure 20 bar

Druck

Maximaldruck von 20 bar

Temperatura

Min. -20 °C/Max. +80 °C

Temperature

Min. -4 °F/Max. +176 °F

Temperatur

Min. -20 °C/Max. +80 °C

Materiali

Corpo: ottone UNI EN 12165 CW617N - UNI EN 12164 CW614N

Sfera: ottone UNI EN 12164 CW614N

Maniglietta: PA 66

Vite: Acciaio

Albero: ottone UNI EN 12164 CW614N

Guarnizioni sede sfera: PTFE

OR: NBR 70

Ogiva: ottone UNI EN 12164 CW614N

Dado: ottone UNI EN 12164 CW614N

Ghiera: ottone UNI EN 12164 CW614N

Materials

Body: brass standard UNI EN 12165 CW617N - UNI EN 12164 CW614N

Ball: brass standard UNI EN 12164 CW614N

Handle: PA66

Screw: Steel

Shaft: brass standard UNI EN 12164 CW614N

Washers ball seat: PTFE

OR: NBR70

Conical seal: brass standard UNI EN 12164 CW614N

Nut: brass standard UNI EN 12164 CW614N

Ring nut: brass standard UNI EN 12164 CW614N

Werkstoffe

Gehäuse: Messing UNI EN 12165 CW617N - UNI EN 12164 CW614N

Kugel: Messing UNI EN 12164 CW614N

Griff: PA66

Schraube: Stahl

Schaft: Messing UNI EN 12164 CW614N

Dichtungen Kugelsitz: PTFE

OR: NBR70

Klemmring: Messing UNI EN 12164 CW614N

Mutter: Messing UNI EN 12164 CW614N

Überwurfmutter: Messing UNI EN 12164 CW614N

Trattamento superficiale

Cromatura

Surface treatment

Chromium - plating

Oberflächenbehandlung

Verchromung

Filettatura

Gas conica ISO 7 (BSPT) BS21 -DIN 2999

Gas cilindrica ISO 228 (BSPP)

Thread

Conical GAS ISO 7 (BSPT) - BS 21 - DIN 2999

Cylindrical GAS ISO 228 (BSPP)

Gewinde

Gas konisch ISO 7 (BSPT) BS21 -DIN 2999

Gas zylindrisch ISO 228 (BSPP)

RV 42



Rubinetti mini ball maschio-femmina

Male/female mini ball valve

Mini Kugelhähne

Code/Code	F"	F1"	P	I	I1	L	L1	H	CH	
RV421818	R1/8	G1/8	5.5	8	8	35.5	19.5	21.5	14	10
RV421418	R1/4	G1/8	5.5	11	8	38	19.5	21.5	14	10
RV421414	R1/4	G1/4	5.5	11	11	41	19.5	21.5	14	10
RV423814	R3/8	G1/4	5.5	11.5	11	41.5	19.5	21.5	14	10
RV423838	R3/8	G3/8	8	11.5	11.5	44.5	19.5	23	18	10
RV421212	R1/2	G1/2	10	15	15	55.5	26.5	33	22	10

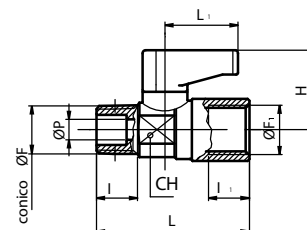

RV 43



Rubinetti mini ball femmina-femmina

Female/female mini ball valve

Mini Kugelhähne

Code/Code	F"	F1"	P	I	I1	L	L1	H	CH	
RV431818	G1/8	G1/8	5.5	8	8	36.5	19.5	21.5	14	10
RV431414	G1/4	G1/4	5.5	11	11	43	19.5	21.5	14	10
RV433838	G3/8	G3/8	8	11.5	11.5	46	19.5	23	18	10
RV431212	G1/2	G1/2	10	15	15	56.5	26.5	33	22	10

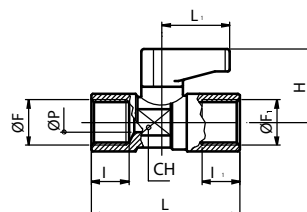

Valvole e rubinetti in ottone

Brass valves
Messing Kugelhähne

RV 36



Rubinetto mini ball maschio-maschio

Male male mini ball valve
Mini Kugelhähne

Codice/Code	F"	F1"	P	I	I1	L	L1	H	CH	■
RV361818	R1/8	G1/8	5.5	8	7	33	19.5	21.5	14	10
RV361814	R1/8	G1/4	5.5	8	7.5	33.5	19.5	21.5	14	10
RV361418	R1/4	G1/8	5.5	11	7	35.5	19.5	21.5	14	10
RV361414	R1/4	G1/4	5.5	11	7.5	36	19.5	21.5	14	10
RV363814	R3/8	G1/4	5.5	11.5	7.5	37	19.5	21.5	14	10
RV363838	R3/8	G3/8	8	11.5	8.5	38.5	19.5	23	18	10
RV361212	R1/2	G1/2	10	15	9.5	51	26.5	33	22	10

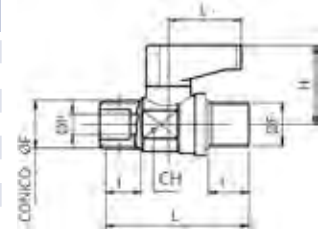

RV 37



Rubinetto mini ball maschio-ogiva

Male-compression mini ball valve
Mini Kugelhähne

Codice/Code	F"	D	P	I	L	L1	H	CH	■
RV371806	R1/8	6	5.5	8	39	19.5	21.5	14	10
RV371406	R1/4	6	5.5	11	42	19.5	21.5	14	10
RV371808	R1/8	8	5.5	8	39	19.5	21.5	14	10
RV371408	R1/4	8	5.5	11	42	19.5	21.5	14	10
RV373808	R3/8	8	5.5	11.5	43	19.5	21.5	14	10

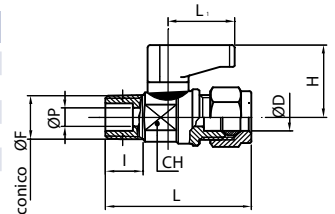

RV 38



Rubinetto mini ball ogiva

Compression mini ball valve
Mini Kugelhähne

Codice/Code	D1	D	P	L	L1	H	CH	■
RV380606	6	6	5.5	47	19.5	21.5	14	10
RV380608	6	8	5.5	48	19.5	21.5	14	10
RV380808	8	8	5.5	49	19.5	21.5	14	10

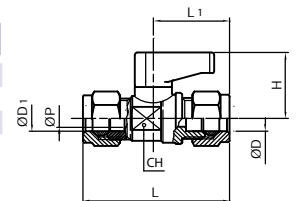

RV 39



Rubinetto mini ball maschio/baionetta

Male-nut milled mini ball valve
Mini Kugelhähne

Codice/Code	F"	P	I	L	L1	H	CH	■
RV391818	R1/8	5.5	8	38.5	19.5	21.5	14	10
RV391414	R1/4	5.5	11	41	19.5	21.5	14	10

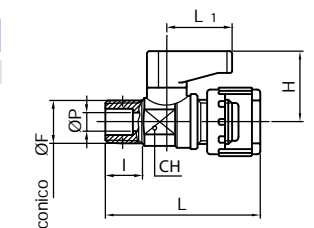

Dati tecnici rubinetti a sfera RV 44-45-49

Ball valve RV 44-45-49 technical data

Technische Daten der Kugelhähne RV 44-45-49

Materiali Corpo valvola: Ottone CW 614N UNI-EN 12164 ricavato da barra esagonale profilata Asta: Ottone CW 614N UNI-EN 12164 Ghiera: Ottone CW 614N UNI-EN 12164 Sfera: Ottone CW 614N UNI-EN 12164 nichelata Guarnizioni della sfera: PTFE (Teflon) Anello di tenuta asta: OR NBR 70 Leva: Nylon 66 caricato vetro	Materials Valve body: CW 614N UNI-EN 12164 made from profiled hexagonal bars Stem: CW 614N UNI-EN 12164 Retainer: CW 614N UNI-EN 12164 Ball: CW 614N UNI-EN 12164 nickel plated Ball gaskets: PTFE (Teflon) Stem sealing ring: OR NBR 70 Lever: glass-charged nylon 66	Werkstoffe Ventilkörper: Messing CW 614N UNI-EN 12164, Aus sechseckige bar-Schiene Auktion: Messing CW 614N UNI-EN 12164 Überwurfmutter: Messing CW 614N UNI-EN 12164 Kugel: Messing CW 614N UNI-EN 12164 vernickelt Dichtungen der Kugel: PTFE (Teflon) Dichtring Auktion: OR NBR 70 Griff: Nylon 66 Glas
Finitura Versione MF/FF: cromata Versione maschio/maschio: nichelata	Surface finishing MF/FF version: chrome plated Male/male version: nickel plated	Endbehandlung MF / FF: chrom MM: vernickelt
Manovra Rotazione di 90° della leva o del cacciavite	Operation 90° lever rotation or screwdriver operation	Betrieb 90 °-Drehung des Hebels oder des Schraubendrehers
Diametro nominale Da 6 mm a 13,5 mm	Nominal diameter From 6 to 13,5 mm	Diameter von 6 bis 13,5 mm
Pressione di esercizio 0 - 10 bar a 90° C	Working pressure 0 - 10 bar at 90° C	Druck 0 - 10 bar am 90° C
Limiti di temperatura - 10 °C / + 90 °C	Temperature limits 14°F / 194°F	Temperatur - 10 °C / + 90 °C
Direzione di passaggio Bidirezionale	Direction Two-ways	Richtung Bidirektional

Valvole e rubinetti in ottone

Brass valves

Messing Kugelhähne

RV 44



Rubinetto a sfera maschio-femmina

Hexagonal mini ball valve male-female
Kugelhähne

Codice/Code	F"	DN	L	H	CH						
RV440018	G1/8	8	39	27.5	21						10
RV440014	G1/4	8	39	27.5	21						10
RV440038	G3/8	8	40	27.6	21						10
RV440012	G1/2	10	45	28.9	24						10
RV440034	G3/4	13.5	51	31.8	30						10

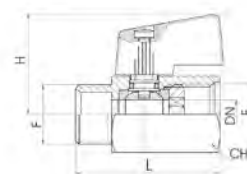

RV 45



Rubinetto a sfera femmina-femmina

Hexagonal mini ball valve female-female
Kugelhähne

Codice/Code	F"	DN	L	H	CH						
RV450018	G1/8	8	39	27.5	21						10
RV450014	G1/4	8	39	27.5	21						10
RV450038	G3/8	8	42	27.5	21						10
RV450012	G1/2	10	47	28.9	24						10
RV450034	G3/4	13.5	54	31.8	30						10

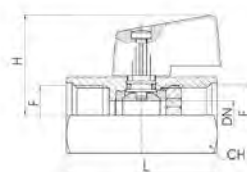

RV 49



Rubinetto a sfera maschio-maschio

Hexagonal mini ball valve male/male
Kugelhähne

Codice/Code	F"	DN	L	H	CH						
RV490014	G1/4	8	40.4	27.6	21						10
RV490038	G3/8	8	42.4	27.6	21						10
RV490012	G1/2	10	49.7	28.9	24						10

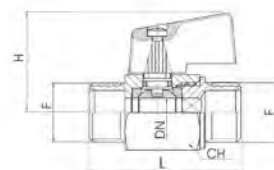

RV 44CP



Rubinetto a sfera mini maschio-femmina

Hexagonal mini ball valve male-female
Mini Kugelhähne

Codice/Code	F"	DN	L	H	CH						
RV440014CP	G1/4	8	43	28.2	20						10
RV440038CP	G3/8	8	44.5	26	20						10
RV440012CP	G1/2	10	43.2	28.2	24						10

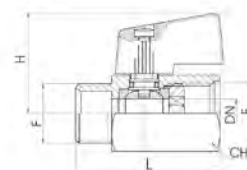

RV 45CP



Rubinetto a sfera mini femmina-femmina

Hexagonal mini ball valve female-female
Mini Kugelhähne

Codice/Code	F"	DN	L	H	CH						
RV450014CP	G1/4	8	41.5	27	20						10
RV450038CP	G3/8	8	44	22.5	20						10
RV450012CP	G1/2	10	44	27.2	24						10

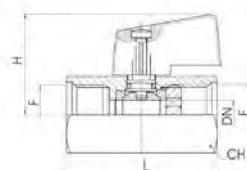

Dati tecnici valvole unidirezionali RV 46V-47V-48V

Unidirectional valves RV 46V-47V-48V technical data

Technische Daten der Einweg Hähne RV 46V-47V-48V

Descrizione

Valvola di non ritorno unidirezionale.
Il sistema con chiusura a sfera da il vantaggio di eliminare l'attrito dei componenti aumentando la durata nel tempo (long life)

Description

Unidirectional valve with ball shutter.
The ball shutter system avoid the friction of the components increasing the live of product (long life)

Beschreibung

Ein Rückschlagventil.
Das System mit Absperrmitteln Ball aus dem Vorteil, dass die Reibung der Komponenten durch Erhöhung der Haltbarkeit (lange Lebensdauer)

Impiego

Aria compressa
Aria compressa lubrificata
Gas vari
Liquidi in genere

Use

Compressed air
Lubricated compressed air
Various gasses
Various liquids

Verwendung

Druckluft
Geölte Druckluft
Verschiedenen Gas
Flüssigkeiten im Allgemeinen

Materiali

Corpo: Ottone CW 614N Nichelato
Pinza: Ottone CW 614N
Sfera: Acciaio Inox AISI 304
Molla: Acciaio Inox AISI 302
O-Ring: FKM

Materials

Body: Brass CW 614N Nickel
Pliers: Brass CW 614N
Ball: Stainless steel AISI 304
Spring: Stainless steel AISI 302
O-Ring: FKM

Werkstoffe

Gehäuse: Messing CW 614N vernickelt
Bremsattel: Brass CW 614N
Kugel: Edelstahl AISI 304
Feder: Edelstahl AISI 302
O-Ringe: FKM

Misure

M5 - 1/8" - 1/4" - 3/8" - 1/2"

Sizes

M5 - 1/8" - 1/4" - 3/8" - 1/2"

Maße

M5 - 1/8" - 1/4" - 3/8" - 1/2"

Filettature

con filetti G – GAS ISO 228
(Rp – R ISO 7 - NPT a richiesta)

Thread

with threads G – GAS ISO 228
(Rp – R ISO 7 - NPT on request)

Gewinde

mit Gewinde G – GAS ISO 228
(Rp – R ISO 7 - NPT auf Anfrage)

Pressione di esercizio

0,5 - 10 bar
50-1000IPa
7 - 145 PSI

Working pressure

0,5 - 10 bar
50-1000IPa
7 - 145 PSI

Betriebsdruck

0,5 - 10 bar
50-1000IPa
7 - 145 PSI

Pressione max di apertura

0,07 bar
7kPa
1PSI min. - max

Opening pressure

0,07 bar
7kPa
1PSI min. - max

Drucköffnung

0,07 bar
7kPa
1PSI min. - max

Temperatura

-5°C + 70°C
+23°F + 160°F

Temperature

-5°C + 70°C
+23°F + 160°F

Temperatur

-5°C + 70°C
+23°F + 160°F

Valvole e rubinetti in ottone

Brass valves

Messing Kugelhähne

RV 46V



Valvola unidirezionale femmina-femmina (FKM)

Unidirectional valve female-female (viton)

Einweg Hähne Viton

Codice/Code	A"	B"	D	L1	L2	L	ES			
RV4600M5V	M5	M5	2.8	6	6	24	10			10
RV460018V	G1/8	G1/8	5	8	8	31	13			10
RV460014V	G1/4	G1/4	7	9.5	9.5	37	16			10
RV460038V	G3/8	G3/8	8.5	10.5	10.5	42	20			10
RV460012V	G1/2	G1/2	10	12	12	50	25			10

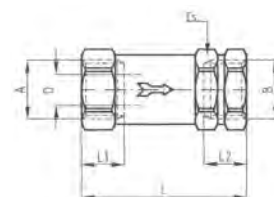

RV 47V



Valvola unidirezionale maschio-femmina (FKM)

Unidirectional valve male-female (viton)

Einweg Hähne Viton

Codice/Code	A"	B"	D	L1	L2	L	ES			
RV470018V	G1/8	G1/8	5	7	8	30	13			10
RV470014V	G1/4	G1/4	7	8	9.5	35	16			10

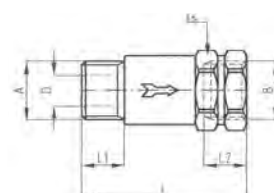

RV 48V



Valvola unidirezionale maschio-maschio (FKM)

Unidirectional valve male-male (viton)

Einweg Hähne Viton

Codice/Code	A"	B"	D	L1	L2	L	ES			
RV480018V	G1/8	G1/8	5	7	7	38	13			10
RV480014V	G1/4	G1/4	7	8	8	44	16			10

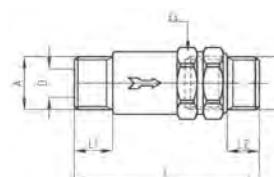

Dati tecnici valvole a sfera (serie media) RV 50-51-52-53-58-59

Ball valves (medium series) RV 50-51-52-53-58-59 technical data
Technische Daten der Kugelhähne (Mittel Serie) RV 50-51-52-53-58-59

Impieghi
Sono adatte per impiantistica idraulica, installazioni idrotermosanitarie, aria compressa ed impianti di irrigazione.

Valvola a sfera a passaggio totale, attacchi filettati F/F - M/F - M/M.
Standard leva rossa

A richiesta leva blu

Omologazioni internazionali

Applications
Are suitable for use in the hydraulic, sanitary, irrigation and compressed air industries.

Full bore ball valve, threaded ends F/F - M/F - M/M.
Standard red lever

On demand blue lever

International approvals

Verwendung
Eignen sich für Hydraulik-, Sanitär-, Druckluft- und Bewässerungssysteme.

Kugelhahn mit vollem Durchgang, Gewinden F/F - M/F - M/M.
Standard roten Hebel

Auf Anfragen blauen Hebel

Internationale Zulassungen

N	Denominazione Part name / Name	Materiale Material / Werkstoff	Trattamento Treatment / Behandlung
1	Corpo Body Körper	Ottone - Brass - Messing CW617N UNI EN 12165/98	Nichelato Nickel plated vernickelt
2	Manicotto Body end Ärmel	Ottone - Brass - Messing CW617N UNI EN 12165/98	Nichelato Nickel plated vernickelt
3	Seggio - Seat - Sitz	PTFE	
4	Sfera Ball Kugel	Ottone - Brass - Messing CW617N UNI EN 12165/98	Cromata Chrome plated chrom
5	Asta - Stem - Stange	Ottone - Brass - Messing CW617N UNI EN 12165/98	
6	O-ring - O-ring - O-Ringe	NBR	
7	Rondella - Seal - Scheibe	PTFE	
8	Premistoppa Packing nut Stopfbuchse	Ottone - Brass - Messing CW617N UNI EN 12165/98	
9	Maniglia - Handle - Griff	Acciaio - Steel - Stahl	Rivestimento PVC Plastic coated PVC
10	Dado - Nut - Mutter	Acciaio - Steel - Stahl	Zincato Nickel plated vernickelt

Dati tecnici Technical data - Technische Daten	
Pressione di esercizio Working pressure Betriebsdruck	1/4" - 1" 32 bar 1 1/4" - 2" 25 bar
Temperatura di esercizio Working temperature Betriebstemperatur	-10°C ÷ +110°C
Filettatura estremità Threaded ends Endgewinde	UNI ISO 228/1
Asta antiscoppio Anti blow-out steam Stange Überdruck	

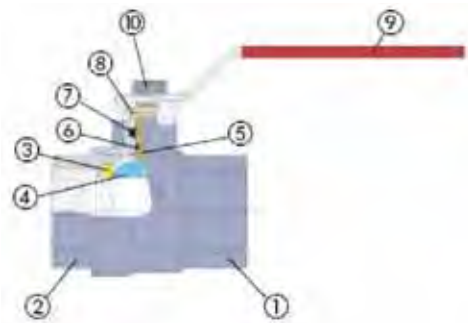

Coefficiente KW KW factor - Koeffizient KW	
1/4" - 10	15
3/8" - 10	15
1/2" - 15	20
3/4" - 20	45
1" - 25	60
1 1/4" - 32	100
1 1/2" - 40	170
2" - 50	265

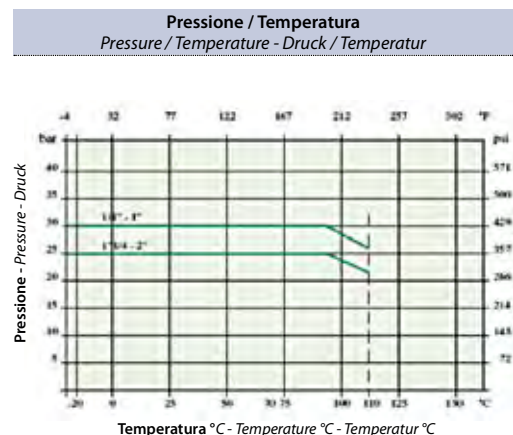
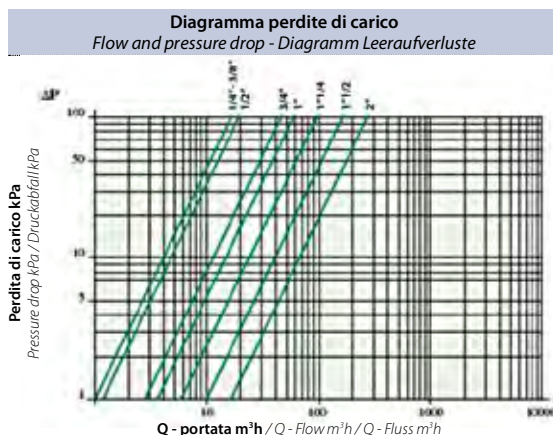

Valvole e rubinetti in ottone

Brass valves

Messing Kugelhähne

RV 50



Valvola a sfera femmina-femmina con leva

Ball valve female-female with lever

Kugelhähne mit hebel

Codice/Code	DN"	Ø	F	S1	H	L	CH					
RV500014	G1/4	10	9	41	35	80	17					1
RV500038	G3/8	10	9	43	36	80	21					1
RV500012	G1/2	15	11	48	42	92	25					1
RV500034	G3/4	20	13	58	44	92	31					1
RV500001	G1	25	15	69	57	115	38					1
RV500114	G1"1/4	32	17	80	61	115	47					1
RV500112	G1"1/2	40	18	91	72	150	54					1
RV500002	G2	50	20,5	108	77	150	66					1
RV500212	G2"1/2	61	20	130	120	240	84					1
RV500003	G3	74	24	150	127	240	96					1
RV500004	G4	95	27	178	135	250	123					1

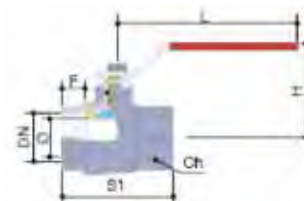

RV 51



Valvola a sfera femmina-femmina con maniglia

Ball valve female-female with handle

Kugelhähne mit handgriff

Codice/Code	DN"	L1										
RV510014	G1/4	52										1
RV510038	G3/8	52										1
RV510012	G1/2	52										1
RV510034	G3/4	52										1
RV510001	G1	62										1

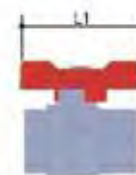

RV 52



Valvola a sfera maschio-femmina con leva

Ball valve male-female with lever

Kugelhähne mit hebel

Codice/Code	DN"	Ø	F	S2	H	L						
RV520014	G1/4	10	9	44	35	80						1
RV520038	G3/8	10	9	44	36	80						1
RV520012	G1/2	15	11	50	42	92						1
RV520034	G3/4	20	13	58	44	92						1
RV520001	G1	25	15	69	57	115						1
RV520114	G1"1/4	32	17	80	61	115						1
RV520112	G1"1/2	40	18	91	72	150						1
RV520002	G2	50	20,5	108	77	150						1

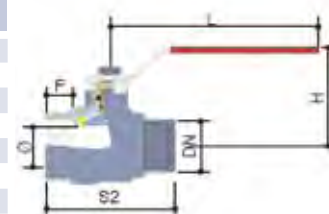

RV 53



Valvola a sfera maschio-femmina con maniglia

Ball valve male-female with handle

Kugelhähne mit handgriff

Codice/Code	DN"	L1										
RV530014	G1/4	52										1
RV530038	G3/8	52										1
RV530012	G1/2	52										1
RV530034	G3/4	52										1
RV530001	G1	62										1

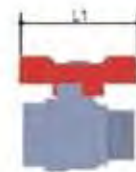

Valvole e rubinetti in ottone

Brass valves
Messing Kugelhähne

Dati tecnici valvole a sfera RV 54-55

Ball valves RV 54-55 technical data

Technische Daten der Kugelhähne RV 54-55

Impieghi

Sono adatte per impiantistica idraulica, installazioni idrotermo-sanitarie, aria compressa.

Valvola a sfera a 3 vie a passaggio ridotto, sfera forata a **L** o **T**, attacchi filettati F/F/F.

Standard leva rossa

A richiesta leva blu

Applications

Are suitable for use in the hydraulic, sanitary, irrigation and compressed.

Three ways reduced bore ball valve, available as either **L** or **T** port threaded ends F/F/F.

Standard red lever

On demand blue lever

Verwendung

Eignen sich für Hydraulik-, Sanitär-, Druckluftsysteme.

Kugelhahn mit vollem Durchgang, Gewinden F/F - M/F - M/M

Standard roten Hebel

Auf Anfragen blauen Hebel

N	Denominazione Part name / Name	Materiale Material / Werkstoff	Trattamento Treatment / Behandlung
1	Corpo Body Körper	Ottone - Brass - Messing CW617N UNI EN 12165/98	Nichelato Nickel plated vernickelt
2	Manicotto Body end Ärmel	Ottone - Brass - Messing CW617N UNI EN 12165/98	Nichelato Nickel plated vernickelt
3	Seggio - Seat - Sitz	PTFE	
4	Sfera Ball Kugel	Ottone - Brass - Messing CW617N UNI EN 12165/98	Cromata Chrome plated chrom
5	Asta - Stem - Stange	Ottone - Brass - Messing CW617N UNI EN 12165/98	
6	Guarnizione asta Stem seat Dichtung des Stange	PTFE	
7	Premistoppa Packing nut - Stopfbuchse	Ottone - Brass - Messing CW617N UNI EN 12165/98	
8	Maniglia - Handle - Griff	Acciaio - Steel - Stahl	Rivestimento PVC Plastic coated PVC
9	Dado - Nut - Mutter	Acciaio - Steel - Stahl	Zincato Nickel plated vernickelt

Dati tecnici Technical data - Technische Daten	
Pressione di esercizio Working pressure Betriebsdruck	1/4" - 1" 32 bar 1 1/4" - 2" 25 bar
Temperatura di esercizio Working temperature Betriebstemperatur	-20°C ÷ +150°C
Filettatura estremità Threaded ends Endgewinde	UNI ISO 228/1

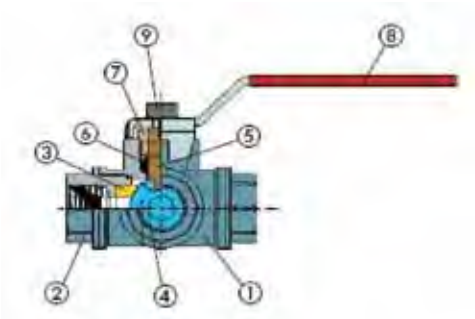

Coefficiente KW KW factor - Koeffizient KW	
1/4" - 10	3
3/8" - 10	3
1/2" - 12	4
3/4" - 15	6
1" - 20	12
1 1/4" - 25	21
1 1/2" - 32	35
2" - 40	47

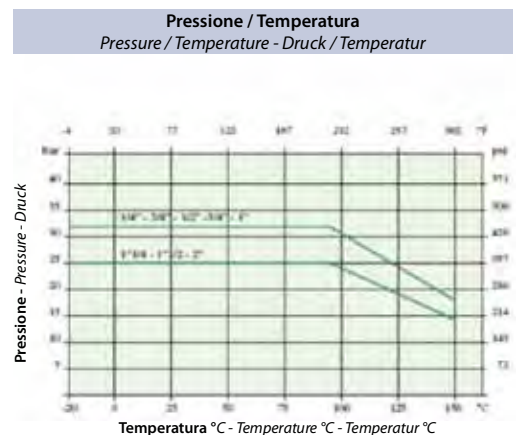
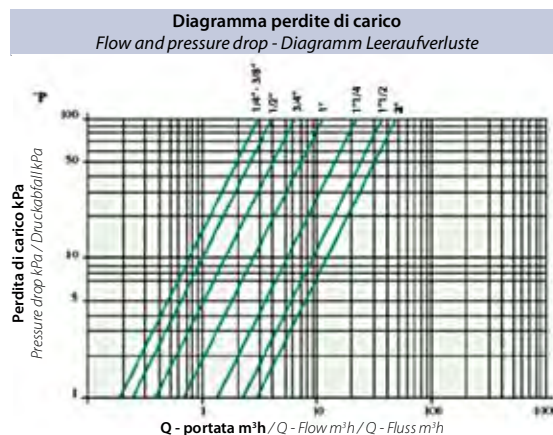

RV 54



Valvole a sfera in ottone F.F.F. (forata a "L")

Brass ball valves F.F.F. (Either "L")
L-Kugelhähne Drei-Wege

Schema di manovra

Operation draft
System der Handlungsspielraum

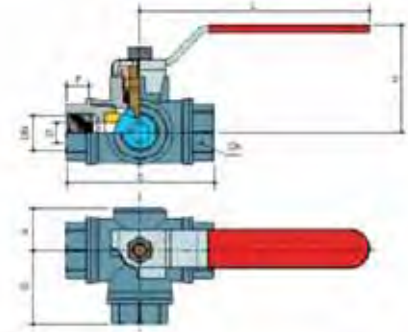

Codice/Code	DN"	Ø	F	S	H	L	A	B	CH		
RV540014	G1/4	10	12	74	58	90	22	37	22		1
RV540038	G3/8	10	12	74	58	90	22	37	22		1
RV540012	G1/2	12	14	80	60	125	24	39	29		1
RV540034	G3/4	15	16	90	64	125	28	46	34		1
RV540001	G1	20	19	105	73	140	31	52	42		1
RV540114	G1"1/4	25	21	115	79	140	35	58	50		1
RV540112	G1"1/2	32	23	138	100	220	42	69	57		1
RV540002	G2	40	26	161	105	220	48	80	68		1

RV 55

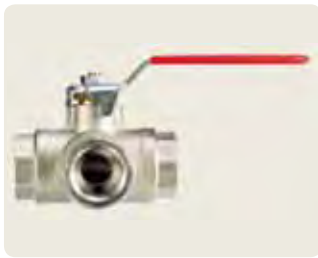

Valvole a sfera in ottone F.F.F. (forata a "T")

Brass ball valves F.F.F. (Either "T")
T-Kugelhähne Drei-Wege

Schema di manovra

Operation draft
System der Handlungsspielraum

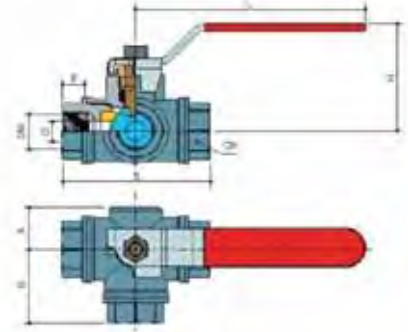

Codice/Code	DN"	Ø	F	S	H	L	A	B	CH		
RV550014	G1/4	10	12	74	58	90	22	37	22		1
RV550038	G3/8	10	12	74	58	90	22	37	22		1
RV550012	G1/2	12	14	80	60	125	24	39	29		1
RV550034	G3/4	15	16	90	64	125	28	46	34		1
RV550001	G1	20	19	105	73	140	31	52	42		1
RV550114	G1"1/4	25	21	115	79	140	35	58	50		1
RV550112	G1"1/2	32	23	138	100	220	42	69	57		1
RV550002	G2	40	26	161	105	220	48	80	68		1

Valvole e rubinetti in ottone

Brass valves

Messing Kugelhähne

Dati tecnici valvole a sfera (serie pesante) RV 60-61-62-63

Ball valves (heavy series) RV 60-61-62-63 technical data
 Technische Daten der Kugelhähne (Schwere Serie) RV 60-61-62-63

Impieghi

Sono adatte per impiantistica idraulica, installazioni idrotermosanitarie, acquedotti, aria compressa.

Valvola a sfera a passaggio totale, attacchi filettati F/F - M/F - M/M.
 Standard leva rossa

A richiesta leva alluminio nera

Omologazioni internazionali



Applications

Are suitable for use in the hydraulic, sanitary, compressed air industries.

Full bore ball valve, threaded ends F/F - M/F - M/M.
 Standard red lever

On demand black aluminum lever

International approvals



Verwendung

Eignen sich für Hydraulik-, Sanitär-, Druckluftsysteme und Wasserleitungen.

Kugelhahn mit vollem Durchgang, Gewinden F/F - M/F - M/M.
 Standard roten Hebel

Auf Anfrage schwarz aluminium Hebel

Internationale Zulassungen



N	Denominazione Part name / Name	Materiale Material / Werkstoff	Trattamento Treatment / Behandlung
1	Corpo Body Körper	Ottone - Brass - Messing CW617N UNI EN 12165/98	Nichelato Nickel plated Vernickelt
2	Manicotto Body end Ärmel	Ottone - Brass - Messing CW617N UNI EN 12165/98	Nichelato Nickel plated Vernickelt
3	Seggio - Seat - Sitz	PTFE	
4	Sfera - Ball - Kugel	Ottone - Brass - Messing CW617N UNI EN 12165/98	Cromata - Chrome plated - Chrom
5	Asta - Stem - Stange	Ottone - Brass - Messing CW617N UNI EN 12165/98	
6	O-ring - O-ring - O-Ringe	FP - fluor carbon rubber Fluor Karbongummi	
7	Guarnizione asta Stem seat Dichtung des Stange	PTFE	
8	Premistoppa Packing nut Stopfbuchse	Ottone - Brass - Messing CW617N UNI EN 12165/98	
9	Maniglia - Handle - Griff	Acciaio - Steel - Stahl	Rivestimento PVC Plastic coated PVC
10	Dado - Nut - Mutter	Acciaio - Steel - Stahl	Zincato - Nickel plated - Vernickelt

Dati tecnici Technical data - Technische Daten	
Pressione di esercizio Working pressure Betriebsdruck	1/4" - 1" 40 bar 1 1/4" - 2" 32 bar 2 1/2" - 4" 25 bar
Temperatura di esercizio Working temperature Betriebstemperatur	-20°C ÷ +150°C
Filettatura estremità Threaded ends Endgewinde	UNI ISO 228/1
Asta antisoppo Anti blow-out steam Stange Überdruck	

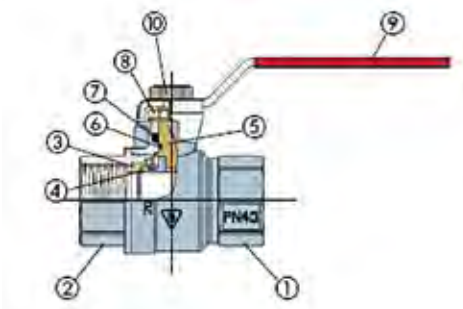

Coefficiente KW KW factor - Koeffizient KW	
1/4" - 10	15
3/8" - 10	15
1/2" - 15	20
3/4" - 20	45
1" - 25	60
1 1/4" - 32	100
1 1/2" - 40	170
2" - 50	265
2 1/2" - 61	510
3" - 74	790
4" - 95	1230

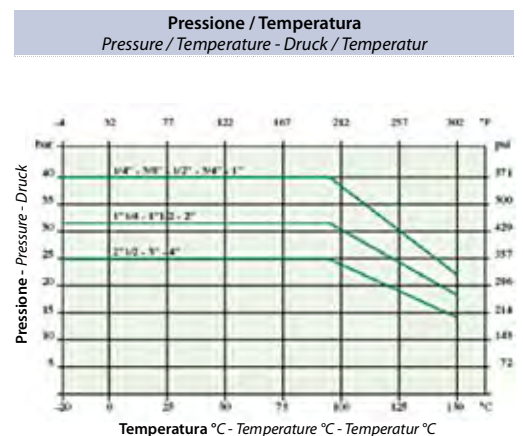
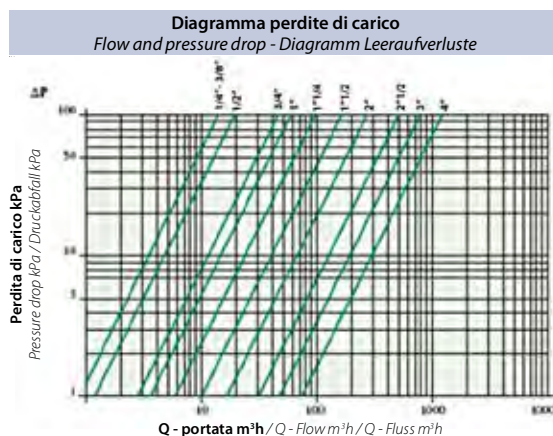

RV 60

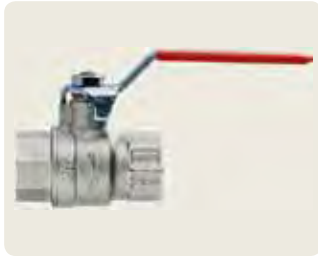

Valvole a sfera in ottone (serie pesante) femmina-femmina

Brass ball valves (heavy serie) female-female
Kugelhähne Messing (Schwere Serie)

Codice/Code	DN"	Ø	F	S1	H	L	CH				
RV600014	G1/4	10	10	45	41	80	21				1
RV600038	G3/8	10	10	45	41	80	21				1
RV600012	G1/2	15	15	63	54	90	26				1
RV600034	G3/4	20	16	71	58	90	31				1
RV600001	G1	25	19	83	66	125	38				1
RV600114	G1"1/4	32	21	92	71	125	48				1
RV600112	G1"1/2	40	21	104	80	140	55				1
RV600002	G2	50	26	124	88	140	68				1

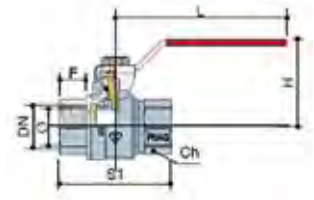

RV 61



Valvole a sfera in ottone (serie pesante) femmina-femmina

Brass ball valves (heavy serie) female-female
Kugelhähne Messing (Schwere Serie)

Codice/Code	DN"	L1									
RV610014	G1/4	52									1
RV610038	G3/8	52									1
RV610012	G1/2	62									1
RV610034	G3/4	62									1
RV610001	G1	72									1



RV 62



Valvole a sfera in ottone (serie pesante) maschio-femmina

Brass ball valves (heavy serie) male-female
Kugelhähne Messing (Schwere Serie)

Codice/Code	DN"	Ø	F	S2	H	L	CH				
RV620014	G1/4	10	10	42	41	80	21				1
RV620038	G3/8	10	10	54	41	80	21				1
RV620012	G1/2	15	15	70	54	90	26				1
RV620034	G3/4	20	16	80	58	90	31				1
RV620001	G1	25	19	92	66	125	38				1
RV620114	G1"1/4	32	21	102	71	125	48				1
RV620112	G1"1/2	40	21	117	80	140	55				1
RV620002	G2	50	26	137	88	140	68				1

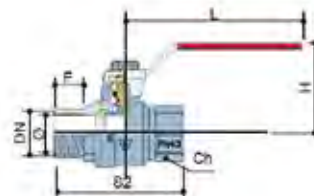

RV 63



Valvole a sfera in ottone (serie pesante) maschio-femmina

Brass ball valves (heavy serie) male-female
Kugelhähne Messing (Schwere Serie)

Codice/Code	DN"	L1									
RV630014	G1/4	52									1
RV630038	G3/8	52									1
RV630012	G1/2	62									1
RV630034	G3/4	62									1
RV630001	G1	72									1

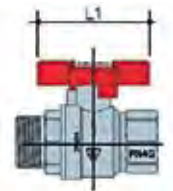

Valvole e rubinetti in ottone

Brass valves

Messing Kugelhähne

Dati tecnici valvole a sfera lucchetable (serie pesante) RV 64

Ball valves lockable handle (heavy series) RV 64 technical data

Technische Daten der Kugelhähne mit Handgriff (Schwere Serie) RV 64

Impieghi

Sono adatte per impiantistica idraulica, installazioni idrotermosanitarie, acquedotti, aria compressa.

Valvola a sfera a passaggio totale, attacchi filettati F/F - M/F - M/M.
Standard leva rossa 

A richiesta leva blu 

Applications

Are suitable for use in the hydraulic, sanitary, compressed air industries.

Full bore ball valve, threaded ends F/F - M/F - M/M.
Standard red lever 

On demand blue lever 

Verwendung

Eignen sich für Hydraulik-, Sanitär-, Druckluftsysteme und Wasserleitungen.

Kugelhahn mit vollem Durchgang, Gewinden F/F - M/F - M/M.
Standard roten Hebel 

Auf Anfragen blauen Hebel 

N	Denominazione Part name / Name	Materiale Material / Werkstoff	Trattamento Treatment / Behandlung
1	Corpo Body Körper	Ottone - Brass - Messing CW617N UNI EN 12165/98	Nichelato Nickel plated Vernickelt
2	Manicotto Body end Ärmel	Ottone - Brass - Messing CW617N UNI EN 12165/98	Nichelato Nickel plated Vernickelt
3	Seggio - Seat - Sitz	PTFE	
4	Sfera - Ball - Kugel	Ottone - Brass - Messing CW617N UNI EN 12165/98	Cromata - Chrome plated - Chrom
5	Asta - Stem - Stange	Ottone - Brass - Messing CW617N UNI EN 12165/98	
6	O-ring - O-ring - O-Ringe	FP - fluor carbon rubber FluorKarbongummi	
7	Guarnizione asta Stem seat Dichtung des Stange	PTFE	
8	Premistoppa Packing nut Stopfbuchse	Ottone - Brass - Messing CW617N UNI EN 12165/98	
9	Maniglia - Handle - Griff	Acciaio - Steel - Stahl	Rivestimento PVC Plastic coated PVC
10	Dado - Nut - Mutter	Acciaio - Steel - Stahl	Zincato - Nickel plated - Vernickelt

Dati tecnici Technical data - Technische Daten	
Pressione di esercizio Working pressure Betriebsdruck	1/4" - 1" 40 bar 1 1/4" - 2" 32 bar 2 1/2" - 4" 25 bar
Temperatura di esercizio Working temperature Betriebstemperatur	-20°C ÷ +150°C
Filettatura estremità Threaded ends Endgewinde	UNI ISO 228/1
Asta antiscoppio Anti blow-out steam Stange Überdruck	

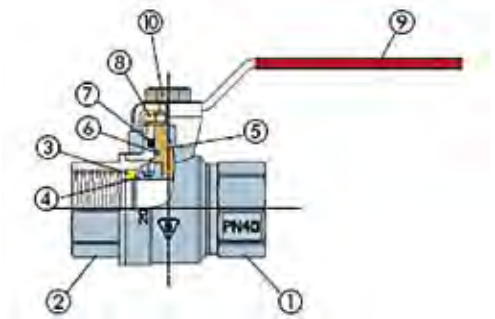

Coefficiente KW KW factor - Koeffizient KW	
1/4" - 10	15
3/8" - 10	15
1/2" - 15	20
3/4" - 20	45
1" - 25	60
1 1/4" - 32	100
1 1/2" - 40	170
2" - 50	265
2 1/2" - 61	510
3" - 74	790
4" - 95	1230

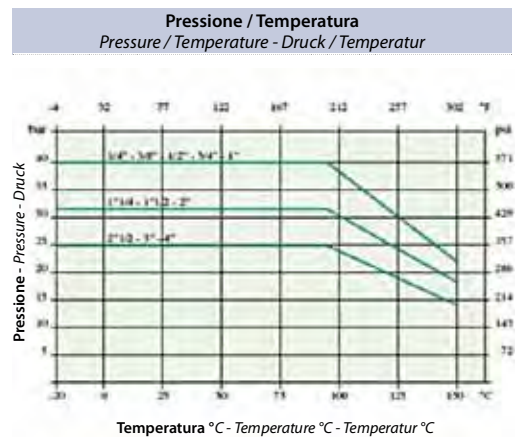
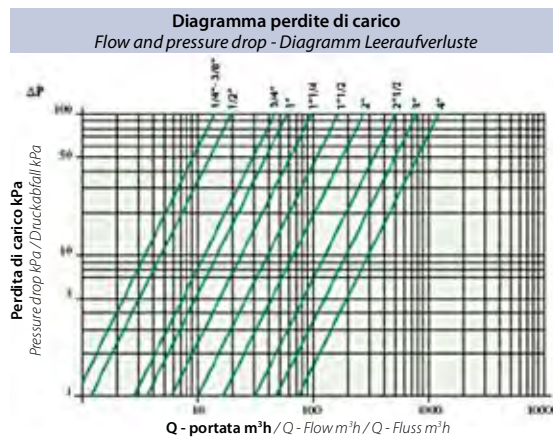

RV 64



Valvole a sfera lucchettabile in ottone femmina-femmina (lucchettabile)

Brass ball valves lockable handle female-female
Kugelhähne mit Handgriff

Codice/Code	DN"	Ø	F	S1	H	L	CH			
RV640014	G1/4"	10	10	45	41	95	21			1
RV640038	G3/8"	10	10	45	41	95	21			1
RV640012	G1/2"	15	15	63	54	120	26			1
RV640034	G3/4"	20	16	71	58	120	31			1
RV640001	G1"	25	19	83	66	150	38			1
RV640114	G1*1/4	32	21	92	71	150	48			1
RV640112	G1*1/2	40	21	104	80	160	55			1
RV640002	G2"	50	26	124	88	160	68			1

Fornita senza lucchetto - Supplied without padlock - Lieferung ohne Schloss

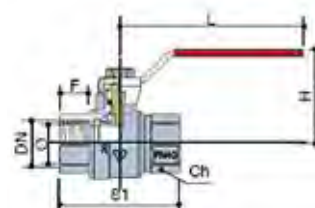

Valvole e rubinetti in ottone

Brass valves
Messing Kugelhähne

Dati tecnici rubinetto di erogazione RV 65

Ball bibcock RV 65 technical data

Technische Daten der Wasserhahn mit Schlauchtülle RV 65

Impieghi

Acqua.

Rubinetto a erogazione a sfera con portagomma.
Standard leva rossa

Applications

Water.

Ball bibcock with hose tail.
Standard red lever

Verwendung

Wasser.

Wasserhahn mit Schlauchtülle.
Standard roten Hebel

N	Denominazione Part name / Name	Materiale Material / Werkstoff	Trattamento Treatment / Behandlung	Dati tecnici Technical data - Technische Daten
1	Corpo Body Körper	Ottone - Brass - Messing CW617N UNI EN 12165/98	Nichelato Nickel plated Vernickelt	Pressione di esercizio Working pressure Betriebsdruck 16 bar
2	Manicotto Body end Ärmel	Ottone - Brass - Messing CW617N UNI EN 12165/98	Nichelato Nickel plated Vernickelt	Temperatura di esercizio Working temperature Betriebstemperatur -10°C ÷ +110°C
3	Seggio - Seat - Sitz	PTFE		Filettatura estremità Threaded ends Endgewinde UNI ISO 228/1
4	Sfera - Ball - Kugel	Ottone - Brass - Messing CW617N UNI EN 12165/98	Cromata - Chrome plated - Chrom	Asta antiscoppio Anti blow-out steam Stange Überdruck
5	Asta - Stem - Stange	Ottone - Brass - Messing CW617N UNI EN 12165/98		
6	O-ring - O-ring - O-Ringe	NBR		
7	Girello Hose tail nut Schlauchtülle Mutter	Ottone - Brass - Messing CW617N UNI EN 12165/98		
8	O-ring - O-ring - O-Ringe	NBR		
9	Portagomma Hose tail Schlauchtülle	Ottone - Brass - Messing CW617N UNI EN 12165/98	Nichelato Nickel plated Vernickelt	
10	Maniglia - Handle - Griff	Acciaio - Steel - Stahl	Rivestimento PVC Plastic coated PVC	
11	Dado - Nut - Mutter	Acciaio - Steel - Stahl	Zincato - Nickel plated - Vernickelt	

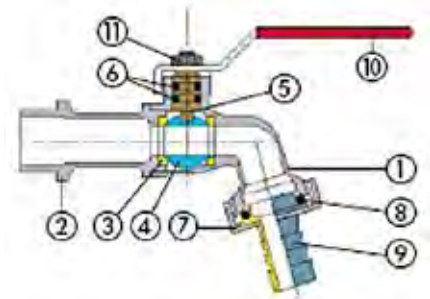

RV 65



Rubinetto di erogazione a sfera con portagomma

Ball bibcock with hose tail
Wasserhahn mit Schlauchtülle

Code/Code	DN"	Ø	F	H	L	A	P		
RV650038	G3/8	12	9.5	38.3	83	50.5	15		1
RV650012	G1/2	15.2	11.5	38.3	83	50.5	15		1
RV650034	G3/4	20	15.5	40	83	59	20.5		1
RV650001	G1	26.5	13	46.6	83	60.6	26		1

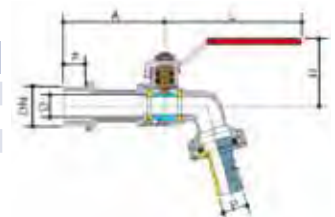

Dati tecnici valvole a sfera anti-legionella RV 66-67-68-69

Anti-legionella ball valves RV 66-67-68-69 technical data

Technische Daten der Kugelhähne für Anti-Legionellen RV 66-67-68-69

Applicazioni

Sono adatte per impianti di distribuzione d'acqua potabile.

Applications

Are suitable for potable water distribution plants.

Verwendung

Eignen sich für Trinkwassersysteme.

Anti-legionella

Il tipo di sfera utilizzata permette di evitare il ristagno dell'acqua nella valvola. In questo modo si evita che i batteri, eventualmente contenuti nell'acqua, possano rimanere a lungo nell'impianto al contrario delle normali valvole.

Anti-legionella

This type of ball prevents water from stagnating in the valve. In this case the bacteria, that may be in water, cannot remain in the piping for a long time unlike the other traditional valves.

Antilegionellen

Die Art der verwendeten Kugel ermöglicht es, die Stagnation des Wassers im Ventil zu vermeiden. Auf diese Weise wird vermieden, dass Bakterien, die im Wasser enthalten sein können, können sie für eine lange Zeit in der Anlage bleiben gegenüber den normalen Ventilen gegenüberliegenden.

Antigelo

Il tipo di sfera utilizzata permette di mantenere sempre in comunicazione corpo valvola-sfera - tubazione, evitando che l'acqua gelando, possa creare pressioni tali sul corpo valvola sino a provocarne la rottura.

Frost-proof

Thanks to this particular shape of the ball the valve body, the ball and the piping are always connected so that frosted water cannot put the valve body under pressure and break it.

Frostsicher

Die Art der verwendete Ball ermöglicht immer in der Kommunikation Ventilkörper - Kugel - Rohr, zu vermeiden, dass das Wasser gefriert, kann ein solcher Druck auf den Ventilkörper erstellen um sie zu veranlassen zu brechen.

Valvola a sfera a passaggio totale, anti-legionella per acqua potabile, attacchi filettati F/F - M/F.

Standard leva verde

Anti-legionella full bore valve for potable water, threaded ends F/F - M/F.

Standard green lever

Kugelhahn mit vollem Durchgang, Antilegionellen für Trinkwasser, Gewinden F/F - M/F.

Standard grünen Hebel

Omologazioni internazionali



International approvals



Internationale Zulassungen



N	Denominazione Part name / Name	Materiale Material / Werkstoff	Trattamento Treatment / Behandlung
1	Corpo - Body - Körper	Ottone - Brass - Messing CW617N UNI EN 12165/98	
2	Manicotto - Body end - Ärmel	Ottone - Brass - Messing CW617N UNI EN 12165/98	
3	Seggio - Seat - Sitz	PTFE	
4	Sfera - Ball - Kugel	Ottone - Brass - Messing CW617N UNI EN 12165/98	
5	Asta - Stem - Stange	Ottone - Brass - Messing CW617N UNI EN 12165/98	
6	O-ring - O-ring - O-Ringe	NBR	
7	Maniglia - Handle - Griff	Acciaio - Steel - Stahl	Rivestimento PVC Plastic coated PVC
8	Dado - Nut - Mutter	Acciaio - Steel - Stahl	Zincato - Nickel plated - Vernickelt

Dati tecnici Technical data - Technische Daten	
Pressione di esercizio Working pressure Betriebsdruck	25 bar
Temperatura di esercizio Working temperature Betriebstemperatur	-10°C ÷ +90°C
Filettatura estremità Threaded ends Endgewinde	UNI ISO 7/1 Rp
Asta anticoppio Anti blow-out stem Stange Überdruck	

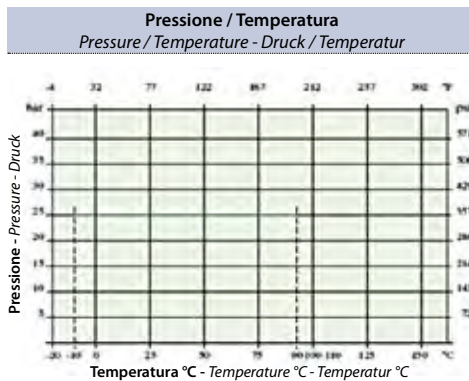
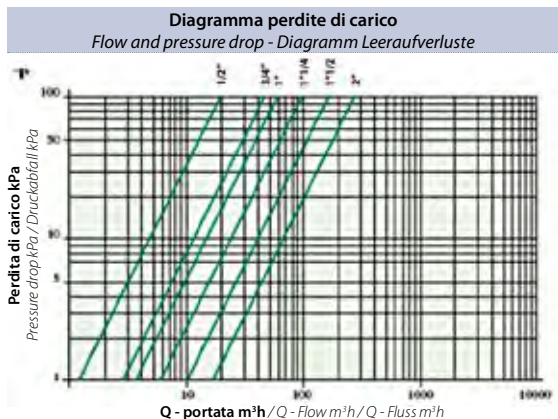
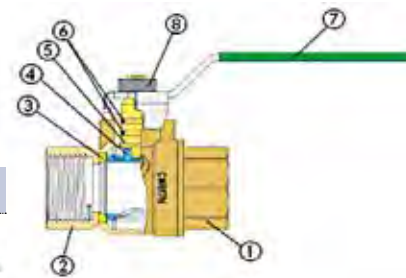

Coefficiente KW KW factor - Koeffizient KW	
1/2" - 15	20
3/4" - 20	45
1" - 25	60
1 1/4" - 32	100
1 1/2" - 40	170
2" - 50	265

Valvole e rubinetti in ottone

Brass valves

Messing Kugelhähne

RV 66



Valvole a sfera in ottone anti-legionella femmina-femmina con leva

Anti-legionella brass ball valves female-female with lever
Kugelhähne für Trinkwasser mit hebel

Codice/Code	DN"	Ø	F	S1	H	L	CH			
RV660038	G3/8	10	10	45	41	80	21			1
RV660012	G1/2	15	15	63	54	90	26			1
RV660034	G3/4	20	16	71	58	90	31			1
RV660001	G1	25	19	83	66	125	38			1
RV660114	G1"1/4	32	21	92	71	125	48			1
RV660112	G1"1/2	40	21	104	80	140	55			1
RV660002	G2	50	26	124	88	140	68			1

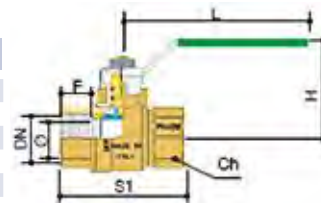

RV 67



Valvole a sfera in ottone anti-legionella femmina-femmina con maniglia

Anti-legionella brass ball valves female-female with handle
Kugelhähne für Trinkwasser mit handgriff

Codice/Code	DN"	L1								
RV670038	G3/8	52								1
RV670012	G1/2	62								1
RV670034	G3/4	62								1
RV670001	G1	72								1

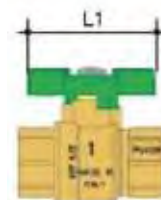

RV 68



Valvole a sfera in ottone anti-legionella maschio-femmina con leva

Anti-legionella brass ball valves male-female with lever
Kugelhähne für Trinkwasser mit hebel

Codice/Code	DN"	Ø	F	S2	H	L	CH			
RV680038	G3/8	10	10	54	41	80	21			1
RV680012	G1/2	15	15	70	54	90	26			1
RV680034	G3/4	20	16	80	58	90	31			1
RV680001	G1	25	19	92	66	125	38			1
RV680114	G1"1/4	32	21	102	71	125	48			1
RV680112	G1"1/2	40	21	117	80	140	55			1
RV680002	G2	50	26	137	88	140	68			1

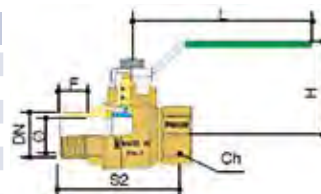

RV 69



Valvole a sfera in ottone anti-legionella maschio-femmina con maniglia

Anti-legionella brass ball valves male-female with handle
Kugelhähne für Trinkwasser mit handgriff

Codice/Code	DN"	L1								
RV690038	G3/8	52								1
RV690012	G1/2	62								1
RV690034	G3/4	62								1
RV690001	G1	72								1

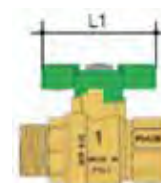

Dati tecnici valvole a sfera per gas RV 70-71-72-73

Ball valves for gas RV 70-71-72-73 technical data

Technische Daten der Kugelhähne für Gas RV 70-71-72-73

Applicazioni

Sono adatte per impianti di distribuzione gas a media e bassa pressione ed idrocarburi.

Valvola a sfera per gas a passaggio totale, attacchi filettati F/F - M/F.

Standard leva giallo

Omologazioni internazionali



Applications

Are suitable for medium and low pressure gas distribution plants and for hydrocarbons.

Full bore ball valve for gas, threaded ends F/F - M/F.

Standard yellow lever

International approvals



Verwendung

Eignen sich für Gasetze bei mittleren und niedrigen Druck und Kohlenwasserstoffe.

Kugelhahn für Gas mit vollem Durchgang, Gewinden F/F - M/F.

Standard gelben Hebel

Internationale Zulassungen



N	Denominazione Part name / Name	Materiale Material / Werkstoff	Trattamento Treatment / Behandlung
1	Corpo - Body - Körper	Ottone - Brass - Messing CW617N UNI EN 12165/98	Nichelato Nickel plated vernickelt
2	Manicotto - Body end - Ärmel	Ottone - Brass - Messing CW617N UNI EN 12165/98	Nichelato Nickel plated vernickelt
3	Seggio - Seat - Sitz	PTFE	
4	Sfera - Ball - Kugel	Ottone - Brass - Messing CW617N UNI EN 12165/98	Cromata - Chrome plated - Chrom
5	Asta - Stem - Stange	Ottone - Brass - Messing CW617N UNI EN 12165/98	
6	O-ring - O-ring - O-Ringe	NBR	
7	Maniglia - Handle - Griff	Acciaio - Steel - Stahl	Rivestimento PVC Plastic coated PVC
8	Dado - Nut - Mutter	Acciaio - Steel - Stahl	Zincato - Nickel plated - Vernickelt

Dati tecnici Technical data - Technische Daten

Pressione di esercizio Working pressure Betriebsdruck	1/4" - 2" 20 bar
Temperatura di esercizio Working temperature Betriebstemperatur	-20°C ÷ +60°C
Filettatura estremità Threaded ends Endgewinde	UNI ISO 7/1 Rp
Asta antiscoppio Anti blow-out steam Stange Überdruck	

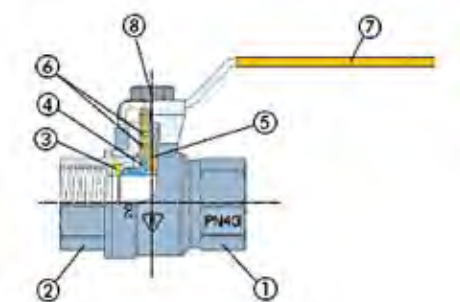

Coefficiente KW KW factor - Koeffizient KW

1/2" - 15	20
3/4" - 20	45
1" - 25	60
1 1/4" - 32	100
1 1/2" - 40	170
2" - 50	265

Diagramma perdite di carico Flow and pressure drop - Diagramm Leeraufverluste

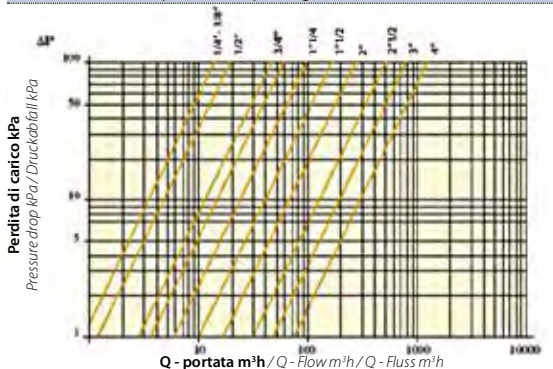

Pressione / Temperatura Pressure / Temperature - Druck / Temperatur

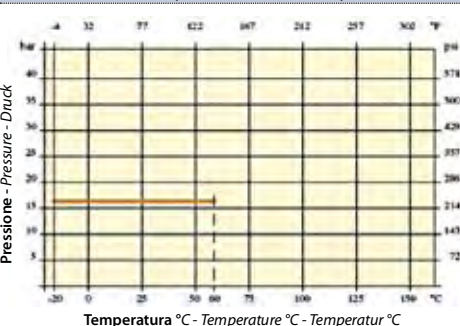

Valvole e rubinetti in ottone

Brass valves

Messing Kugelhähne

RV 70

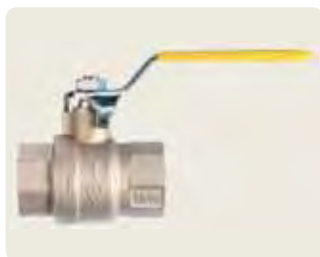

Valvole a sfera in ottone (per gas) femmina-femmina con leva

Brass ball valves (for gas) female-female with handle
Kugelhähne für Gas mit Hebel

Codice/Code	DN"	Ø	F	S1	H	L	CH			
RV700038	3/8	10	10	45	41	80	21			1
RV700012	1/2	15	15	63	54	90	26			1
RV700034	3/4	20	16	71	58	90	31			1
RV700001	1	25	19	83	66	125	38			1
RV700114	1"1/4	32	21	92	71	125	48			1
RV700112	1"1/2	40	21	104	80	140	55			1
RV700002	2	50	26	124	88	140	68			1

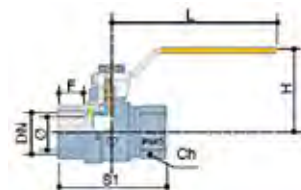

RV 71

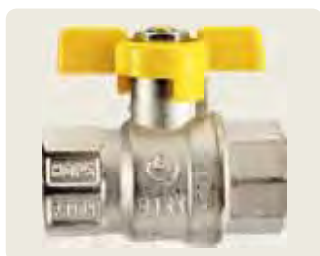

Valvole a sfera in ottone (per gas) femmina-femmina con maniglia

Brass ball valves (for gas) female-female with handle
Kugelhähne für Gas mit handgriff

Codice/Code	DN"	L1								
RV710038	3/8	52								1
RV710012	1/2	62								1
RV710034	3/4	62								1
RV710001	1	72								1

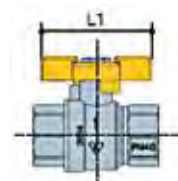

RV 72



Valvole a sfera in ottone (per gas) maschio-femmina con leva

Brass ball valves (for gas) male-female with handle
Kugelhähne für Gas mit Hebel

Codice/Code	DN"	Ø	F	S2	H	L	CH			
RV720038	3/8	10	10	54	41	80	21			1
RV720012	1/2	15	15	70	54	90	26			1
RV720034	3/4	20	16	80	58	90	31			1
RV720001	1	25	19	92	66	125	38			1
RV720114	1"1/4	32	21	102	71	125	48			1
RV720112	1"1/2	40	21	117	80	140	55			1
RV720002	2	50	26	137	88	140	68			1

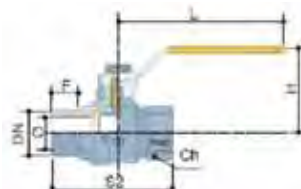

RV 73



Valvole a sfera in ottone (per gas) maschio-femmina con maniglia

Brass ball valves (for gas) male-female with handle
Kugelhähne für Gas mit handgriff

Codice/Code	DN"	L1								
RV710038	3/8	52								1
RV710012	1/2	62								1
RV710034	3/4	62								1
RV710001	1	72								1

